

Versatile™ 4C Mailbox, 4C15D-13

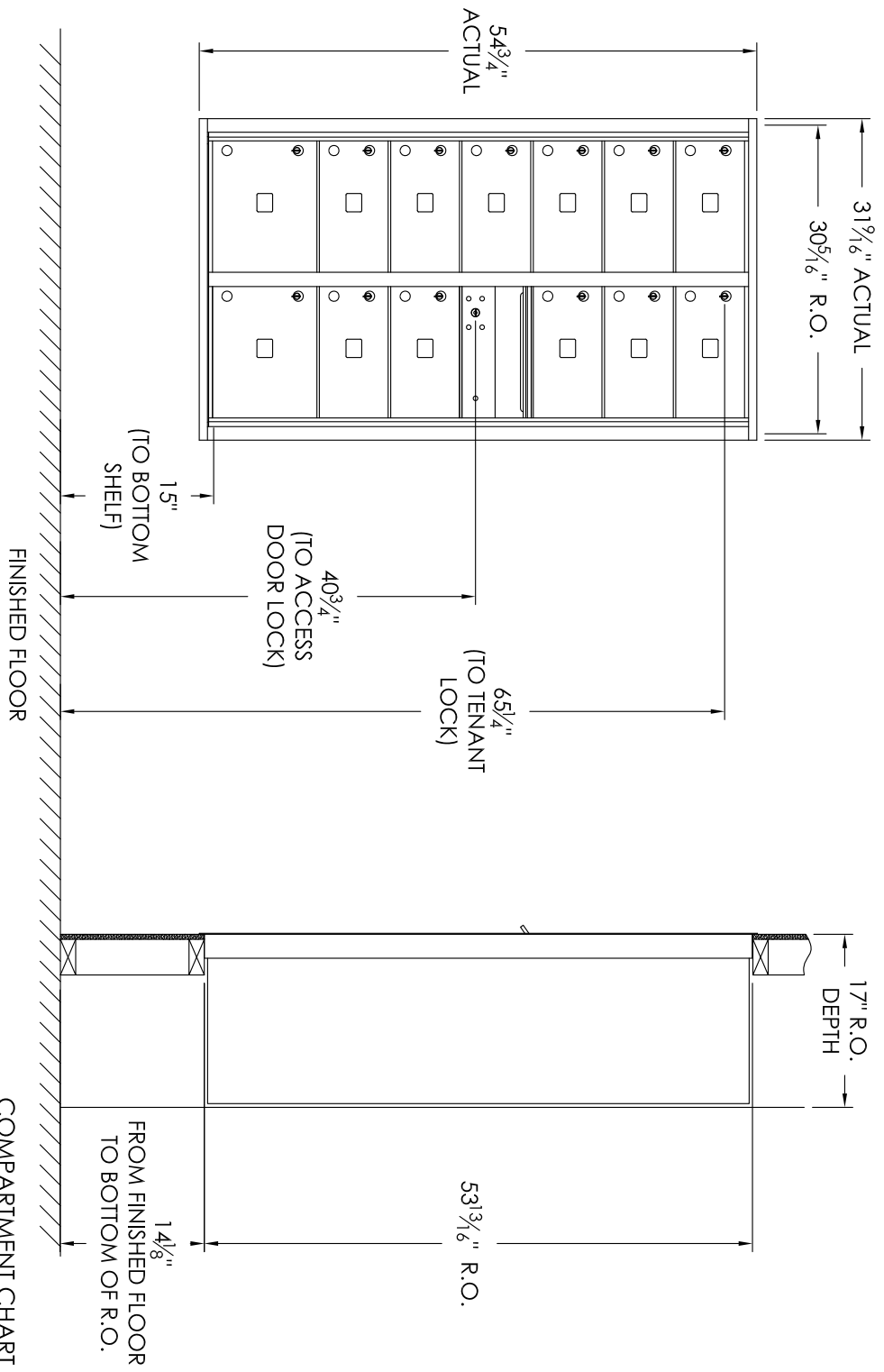

COMPARTMENT CHART

DESCRIPTION	COMPARTMENT	COMPARTMENT SIZE	QTY.
MAILBOX	MB2	6-1 1/2" H x 12" W x 15" D	11
MAILBOX	MB3	10" H x 12" W x 15" D	2
OUTGOING MAIL	OM2	6-1 1/2" H x 12" W x 15" D	1

PRODUCT SERIES: VERSATILE™ 4C FRONT LOAD MAILBOX



1743 Quinny Ave. Suite 151
 Naperville, IL 60540
 800-824-9985
 www.MailboxWorks.com

MODEL	REV	REV
4C15D-13	B	B
SCALE	NONE	LAST REV DATE
NONE	5/12/14	
DRAWING NUMBER	DRAWN BY	
4C15D-13CS	RS	

- Notes:**
- This module does NOT meet USPS STD-4C installation specification requirements as shown below:
 - At least one customer compartment shall be positioned less than 48" above finished floor (AFF).
 - No parcel locker (interior bottom shelf) shall be positioned less than 15" AFF.
 - No patron (tenant) lock shall be positioned more than 67" AFF.
 - No customer compartment (interior bottom shelf) shall be positioned less than 28" AFF.
 - The USPS Arrow lock shall be positioned 36"-48" AFF.
 - This 4C mailbox is to be used for private applications.
 - The rough opening width for multi-unit 4C installations = (the sum of all actual unit widths) - 1 1/8".