

versatile™ 4C Surface Mount Collar, SM16S

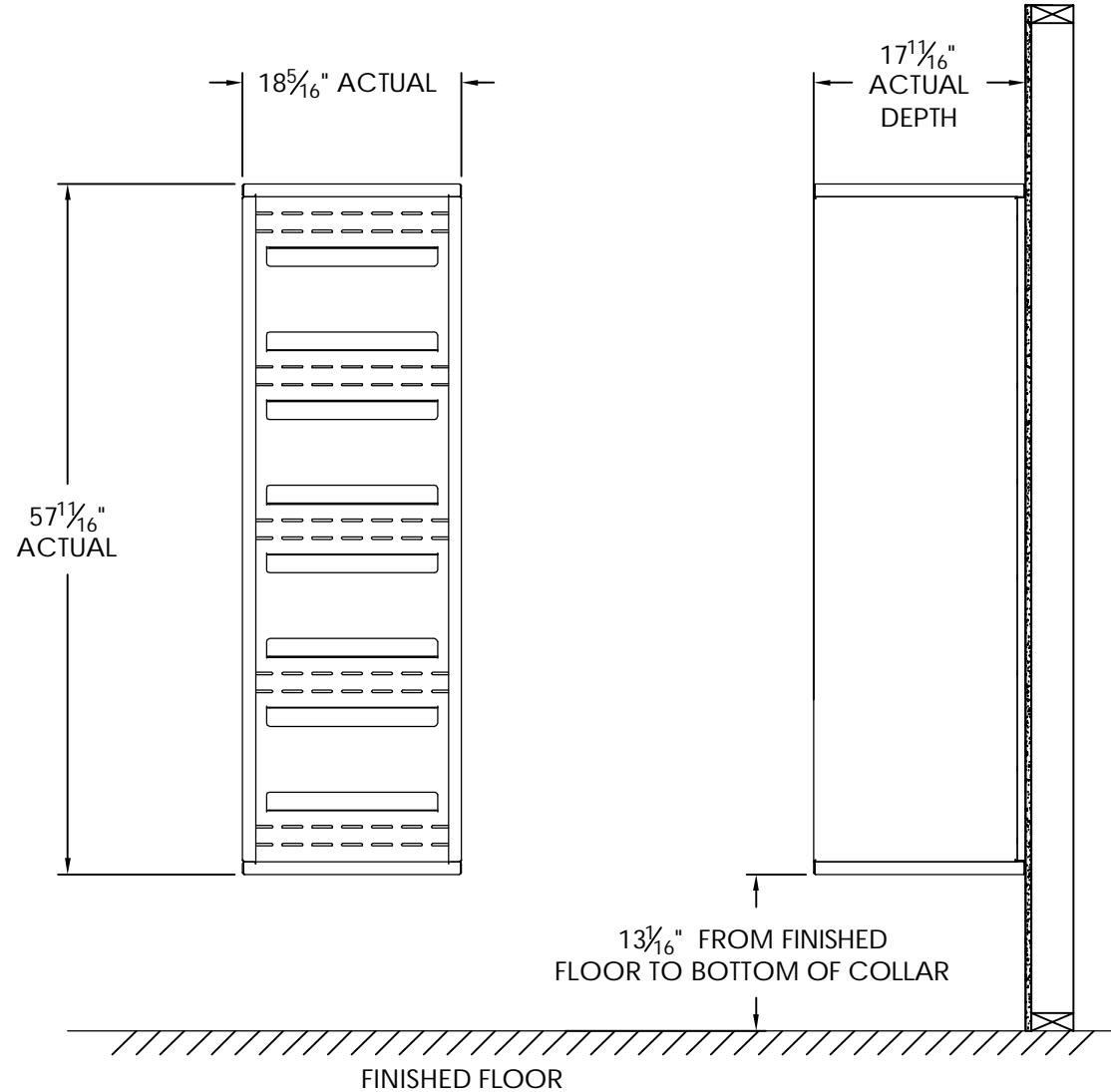

Notes:

1. Designed to mount Florence Versatile™ 4C mailbox single column Max Height Suite modules (sold separately).
2. For use with front loading modules only.

PRODUCT SERIES: VERSATILE™ 4C SURFACE MOUNT COLLAR

MODEL	SM16S	REV	C
SCALE	NONE	LAST REV DATE	7/03/2014
DRAWING NUMBER	SM16SCS	DRAWN BY	TNS

versatile™ 4C Mailbox, 4C16S-14

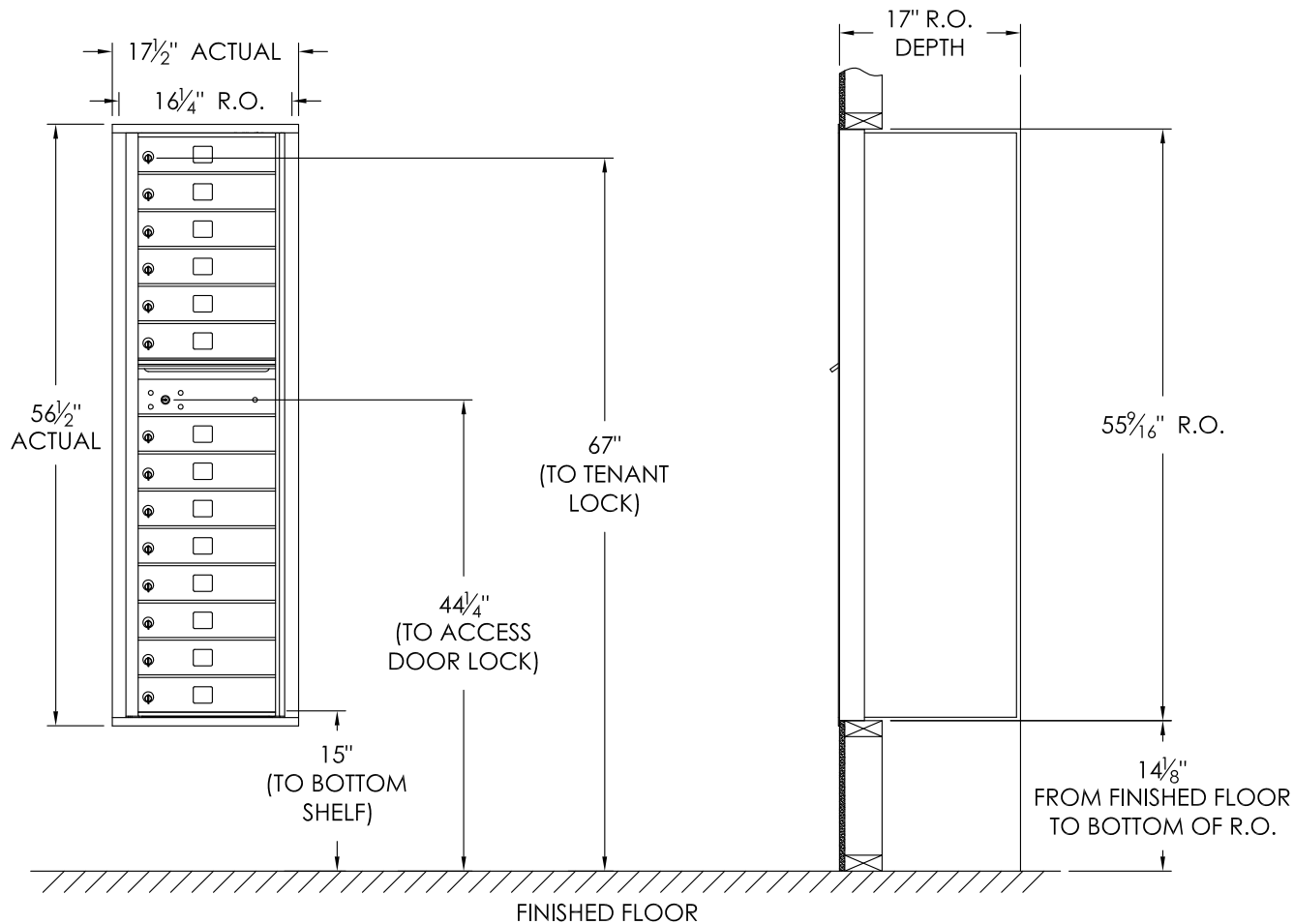

COMPARTMENT CHART

DESCRIPTION	COMPARTMENT	COMPARTMENT SIZE	QTY.
MAILBOX	MB1	3" H x 12" W x 15" D	14
OUTGOING MAIL	OM1	3" H x 12" W x 15" D	1

Notes:

1. This module does NOT meet USPS STD-4C installation specification requirements because there are customer compartments (interior bottom shelf) positioned less than 28" AFF.
2. This 4C mailbox can be used for private applications.
3. The rough opening width for multi-unit 4C installations = (the sum of all actual unit widths) - 1 1/8".

PRODUCT SERIES:

VERSATILE™ 4C FRONT LOAD MAILBOX

MODEL	4C16S-14	REV	D
SCALE	NONE	LAST REV DATE	01/04/2019
DRAWING NUMBER	4C16S-14CS	DRAWN BY	SDH