

versatile™ 4C Surface Mount Collar, SM12D

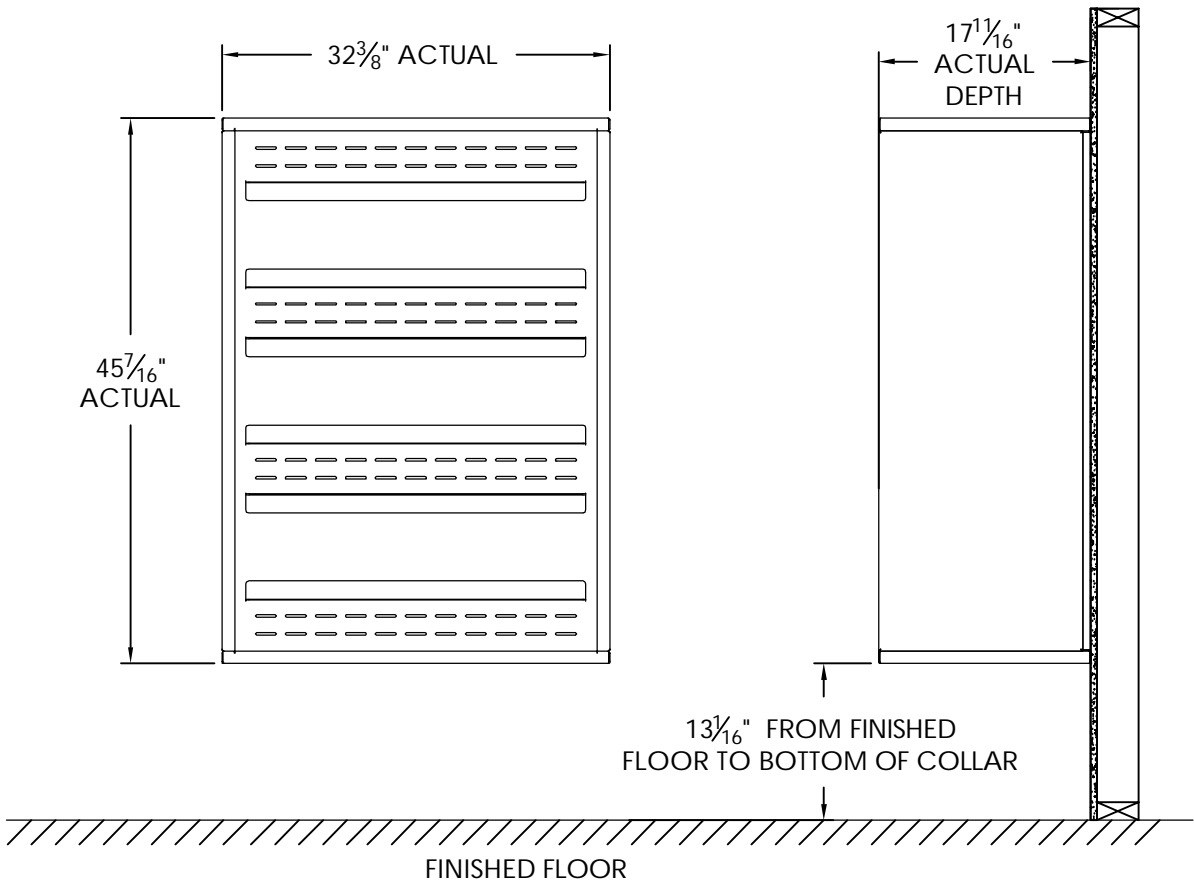

- Notes:
- 1. Designed to mount Florence Versatile™ 4C mailbox double column 12-High Suite modules (sold separately).
 - 2. For use with front loading modules only.

PRODUCT SERIES: VERSATILE™ 4C SURFACE MOUNT COLLAR			
	MODEL	SM12D	REV B
	SCALE	NONE	LAST REV DATE 7/02/2014
	DRAWING NUMBER SM12DCS		DRAWN BY TNS

versatile™ 4C Mailbox, 4C12D-22

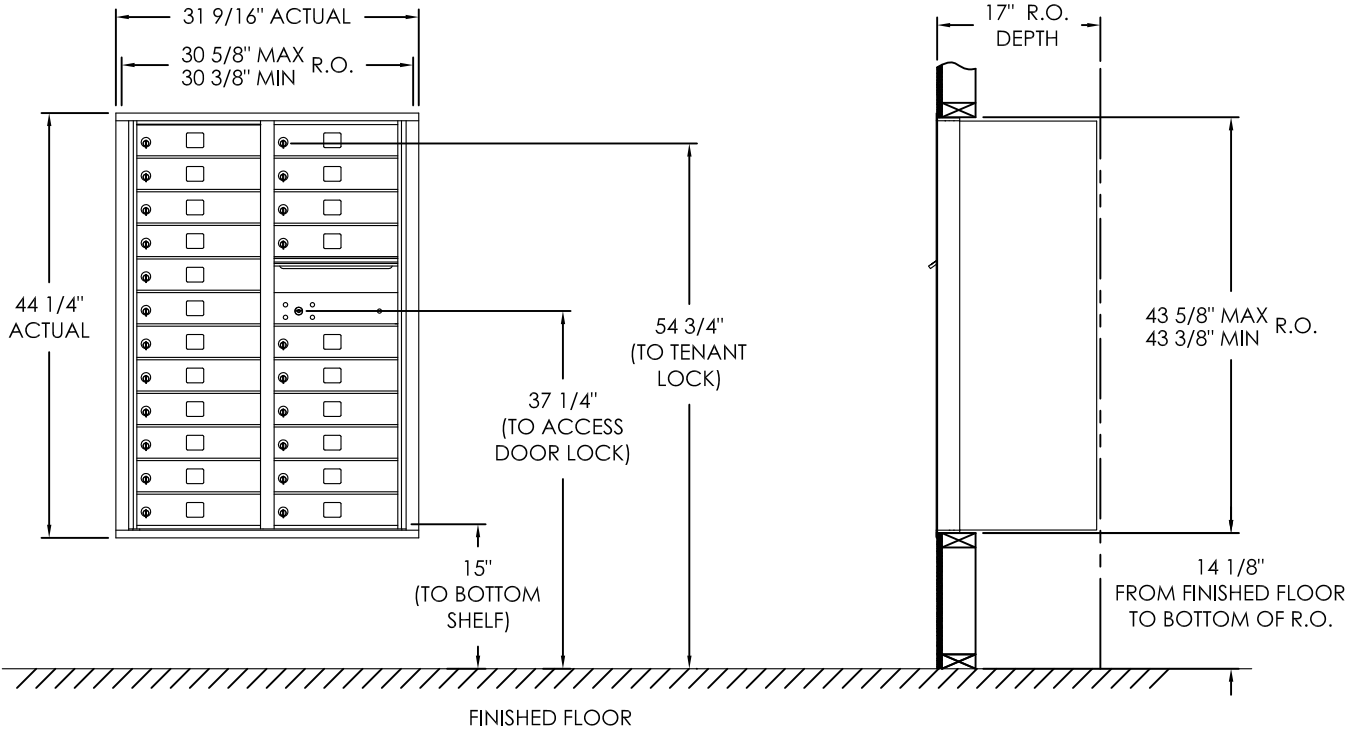

COMPARTMENT CHART

DESCRIPTION	COMPARTMENT	COMPARTMENT SIZE	QTY.
MAILBOX	MB1	3" H x 12" W x 15" D	22
OUTGOING MAIL	OM2	6-1/2" H x 12" W x 15" D	1

- Notes:
1. This module does NOT meet USPS STD-4C installation specification requirements because there are customer compartments (interior bottom shelf) positioned less than 28" AFF.
 2. This 4C mailbox can be used for private applications.
 3. The rough opening width for multi-unit 4C installations is provided using the Florence configurator: www.florencemailboxes.com/configurator.

PRODUCT SERIES: VERSATILE™ 4C FRONT LOAD MAILBOX

	MODEL	4C12D-22	REV	E
	SCALE	NONE	LAST REV DATE	07/02/19
	DRAWING NUMBER		DRAWN BY	
	4C12D-22CS		RAK	